

# Development Land For Sale Or Joint Venture

**The Present Zoning: RMF-Multiple Family Residential [Allows]**

- 1. Single-Family Homes**
- 2. Duplexes**
- 3. Apartments**
- 4. Townhouses**



Call Waymon About a  
Joint Venture  
**863-287-5981**

**Tri-Plexes**



**Single Family Homs**



**Townhouse**



**Apartments**



*Magnificent*



# Dependable Income Stream

Apartments better than the Stock Market, lower risk, yields better returns, and offers greater diversification.



Come see this alluring development property approved for **Apartments Townhouses/Single-family Homes and more.** You will be captivated by its panoramic view overlooking Lake Marie from top of the Ridge of Dundee. The land gradually slopes toward the lake guaranteeing apartment owners will have a magnificent obsession living on this unique property. We are told location is critical to a community value and this unique property meets that criteria plus much more. It's a short distance to **Disney World**, yet far enough to make it quite from noisy highway traffic. This quaint small town is filled with neighbors who know each other and enjoy community activities together. Come see, come buy before it is too late. **Owner financing or will JV the project.**



MLS # K 4900731





# Stately

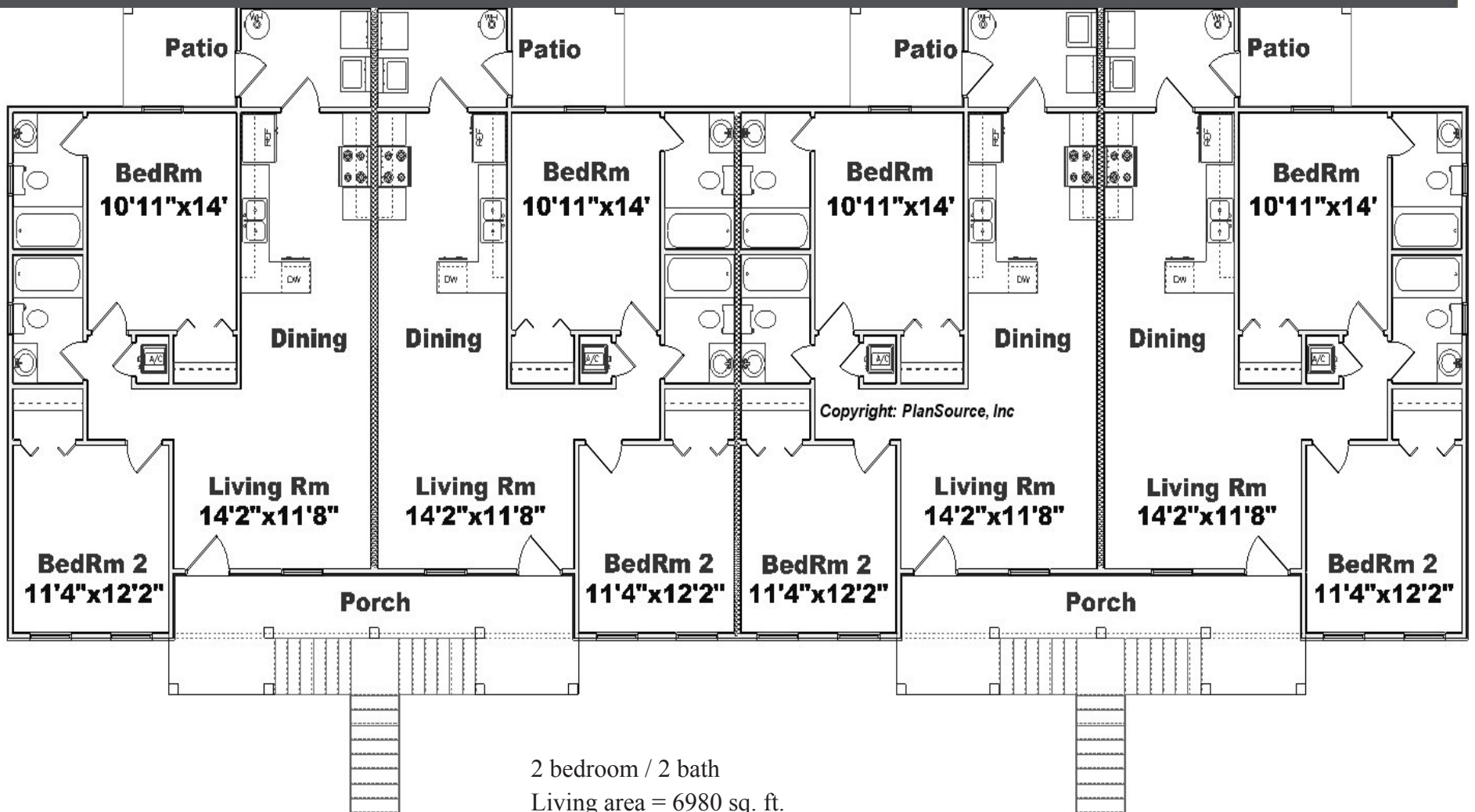

2 bedroom / 2 bath  
 Living area = 6980 sq. ft.  
 Other = 464 sq. ft.  
 Total = 7444 sq. ft.  
 Living area per unit: ~872 sq. ft.



Developing the property for Apartments is not only the most economic way to develop Lake Marie Villa, but zoning allows up to 56 units. You must verify this information with the Town of Dundee Planner Committee. City water in next to the property and city sewer is only a short distance.

We plan for a private Lift Station like Dell Lake Village MHP and Sertoma Camp Endeavor.

Waymon Ellis Meadows - Licesed Real Estate Broker and Builder  
404 Ridgewood Avenue - Dundee, Florida 33838  
Phone: 863-287-5981 - Email: BigW1937@aol.com

*Information is believed to  
true but not guaranteed.*